

Memory Care

CERULEAN - Private Suite 393 Sq. Ft.*

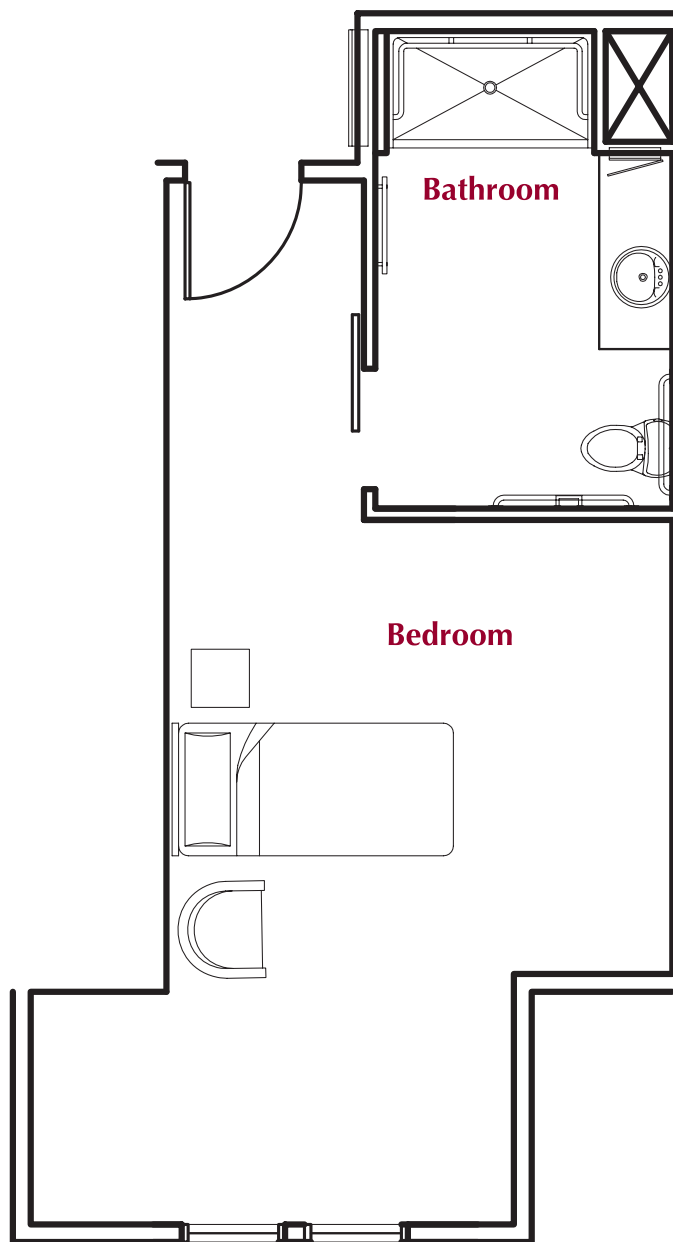

Waterford Grand

Assisted Living and Memory Care

The Difference Between Living and Living Well

600 Waterford Way | Eugene, OR 97401
541-636-3329 | www.WaterfordGrand.com

*Square footage estimates based on architectural drawings

The Difference Between Living and Living Well



Memory Care

AZURE - Private Suite 397 Sq. Ft.*

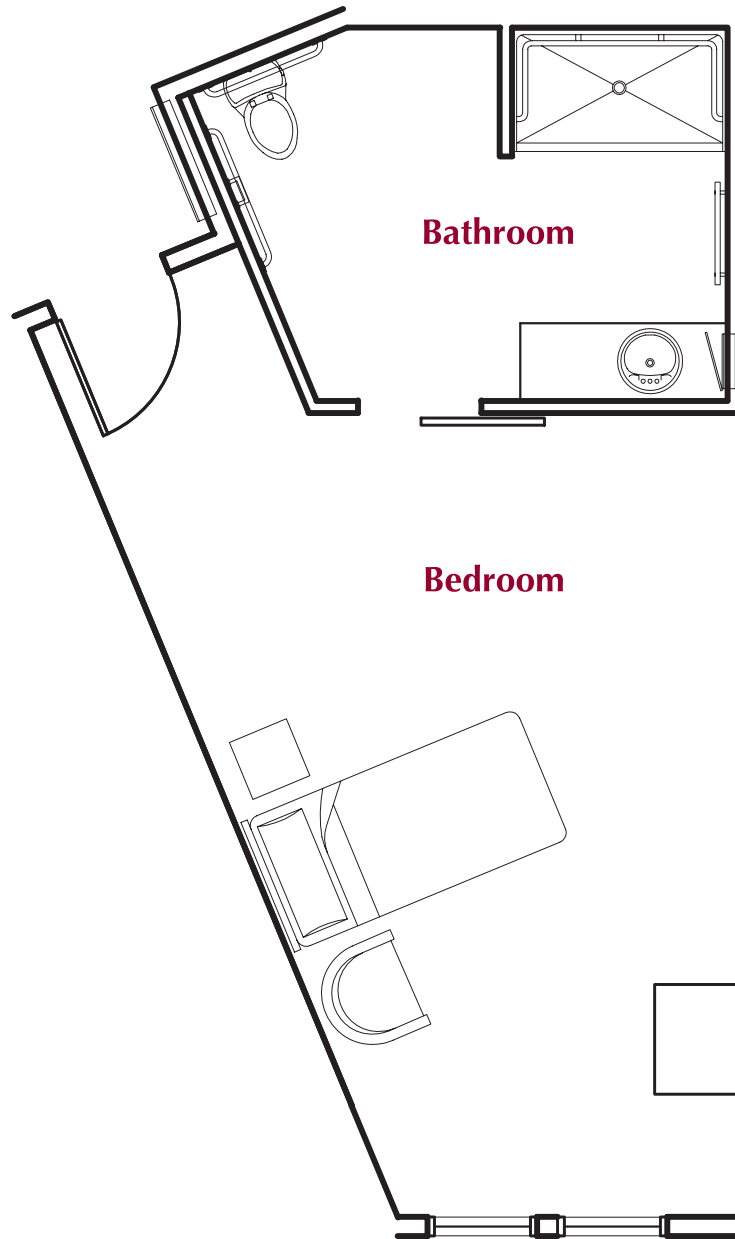

Waterford Grand

Assisted Living and Memory Care

The Difference Between Living and Living Well

600 Waterford Way | Eugene, OR 97401
541-636-3329 | www.WaterfordGrand.com

*Square footage estimates based on architectural drawings

The Difference Between Living and Living Well



Memory Care

CITRON - Private Suite 305 Sq. Ft.*

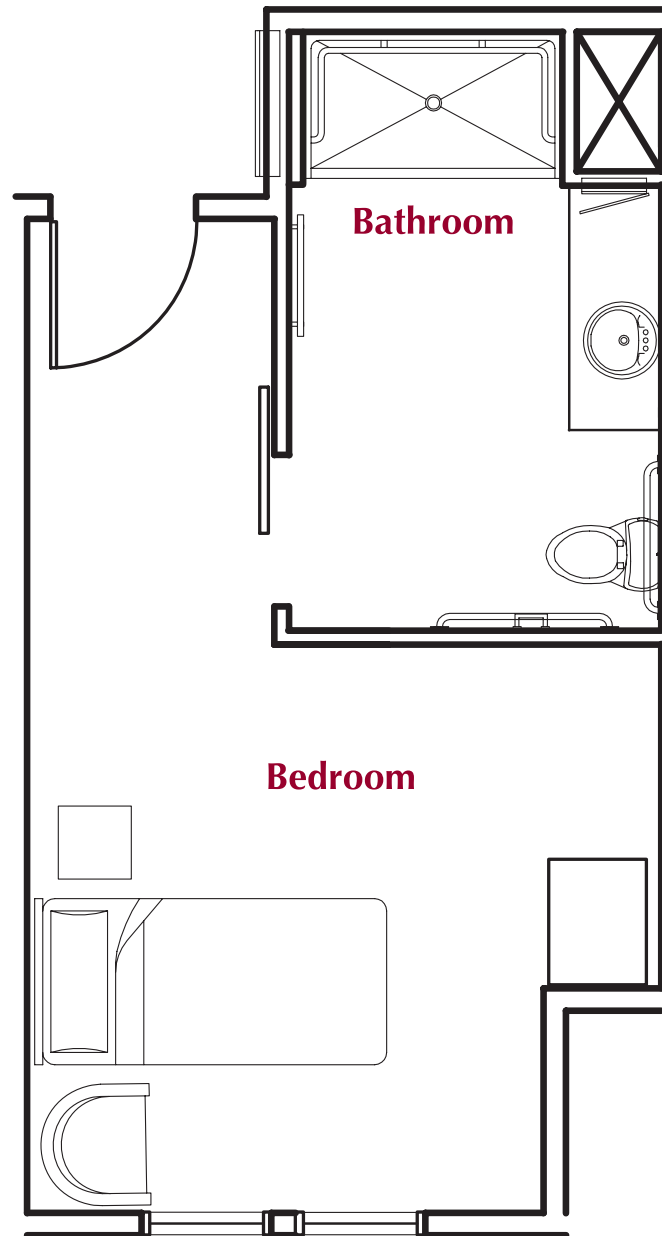

Waterford Grand
Assisted Living and Memory Care

The Difference Between Living and Living Well

600 Waterford Way | Eugene, OR 97401
541-636-3329 | www.WaterfordGrand.com

*Square footage estimates based on architectural drawings

The Difference Between Living and Living Well



Memory Care

CELADON - Private Suite 317 Sq. Ft.*

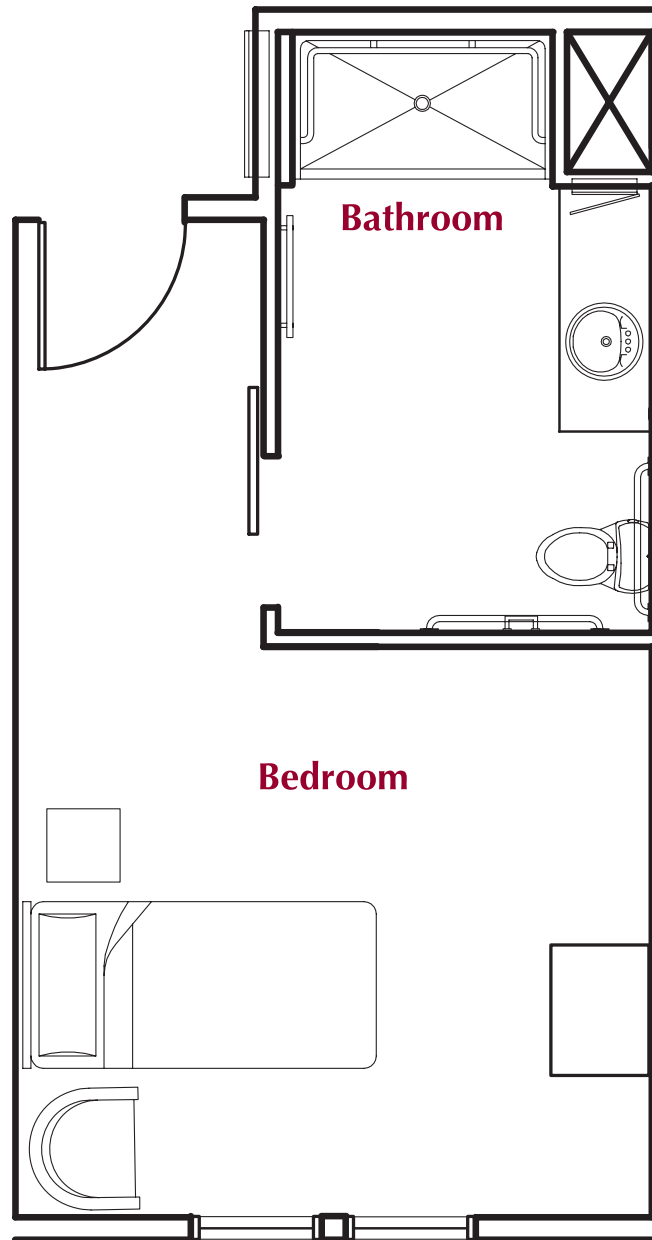

Waterford Grand

Assisted Living and Memory Care

The Difference Between Living and Living Well

600 Waterford Way | Eugene, OR 97401
541-636-3329 | www.WaterfordGrand.com

*Square footage estimates based on architectural drawings

The Difference Between Living and Living Well



Memory Care

COBALT - Companion Suite 293 Sq. Ft.*

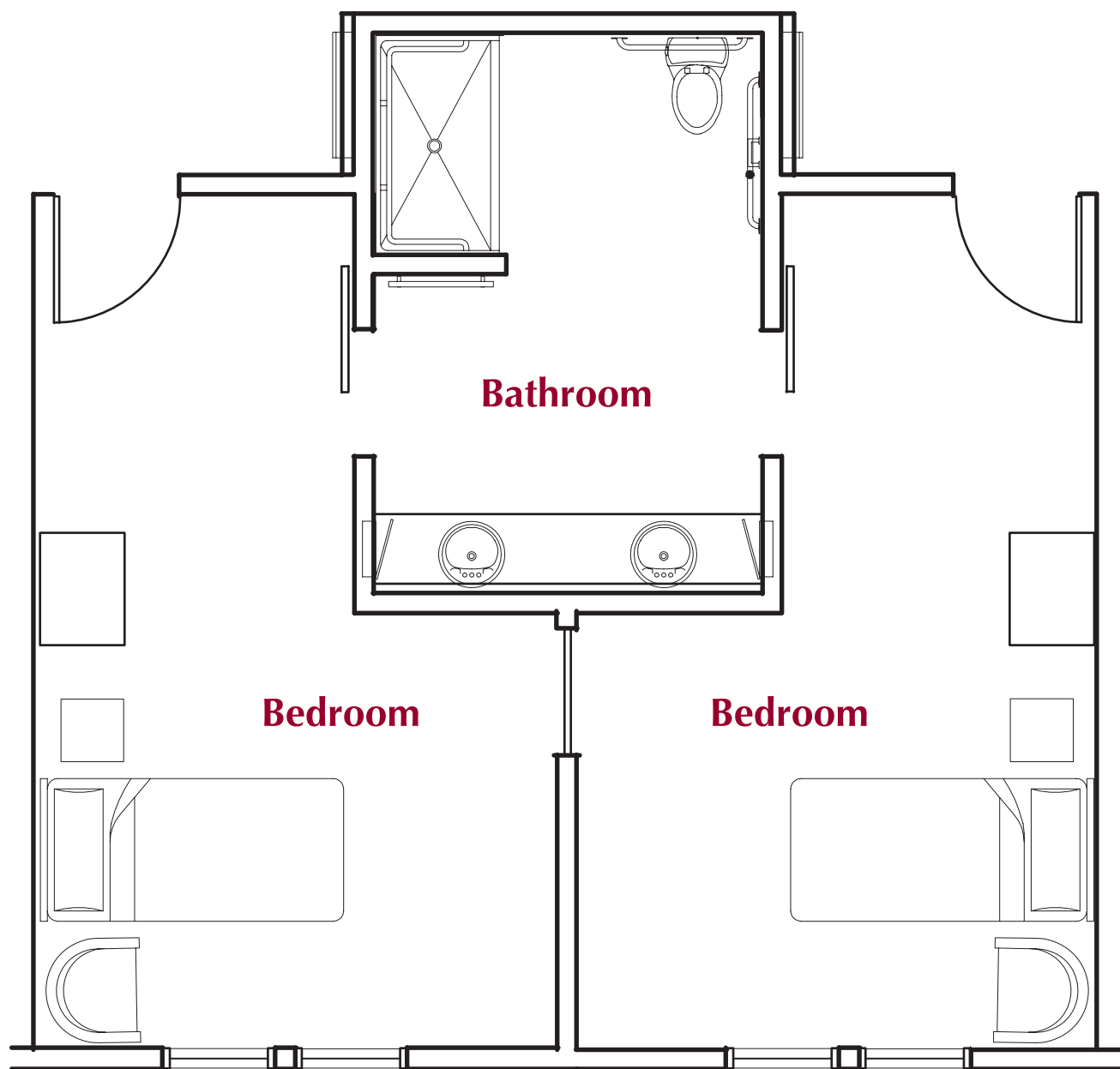

Waterford Grand

Assisted Living and Memory Care

The Difference Between Living and Living Well

600 Waterford Way | Eugene, OR 97401
541-636-3329 | www.WaterfordGrand.com

*Square footage estimates based on architectural drawings

The Difference Between Living and Living Well



Memory Care

INDIGO - Companion Suite 329 Sq. Ft.*

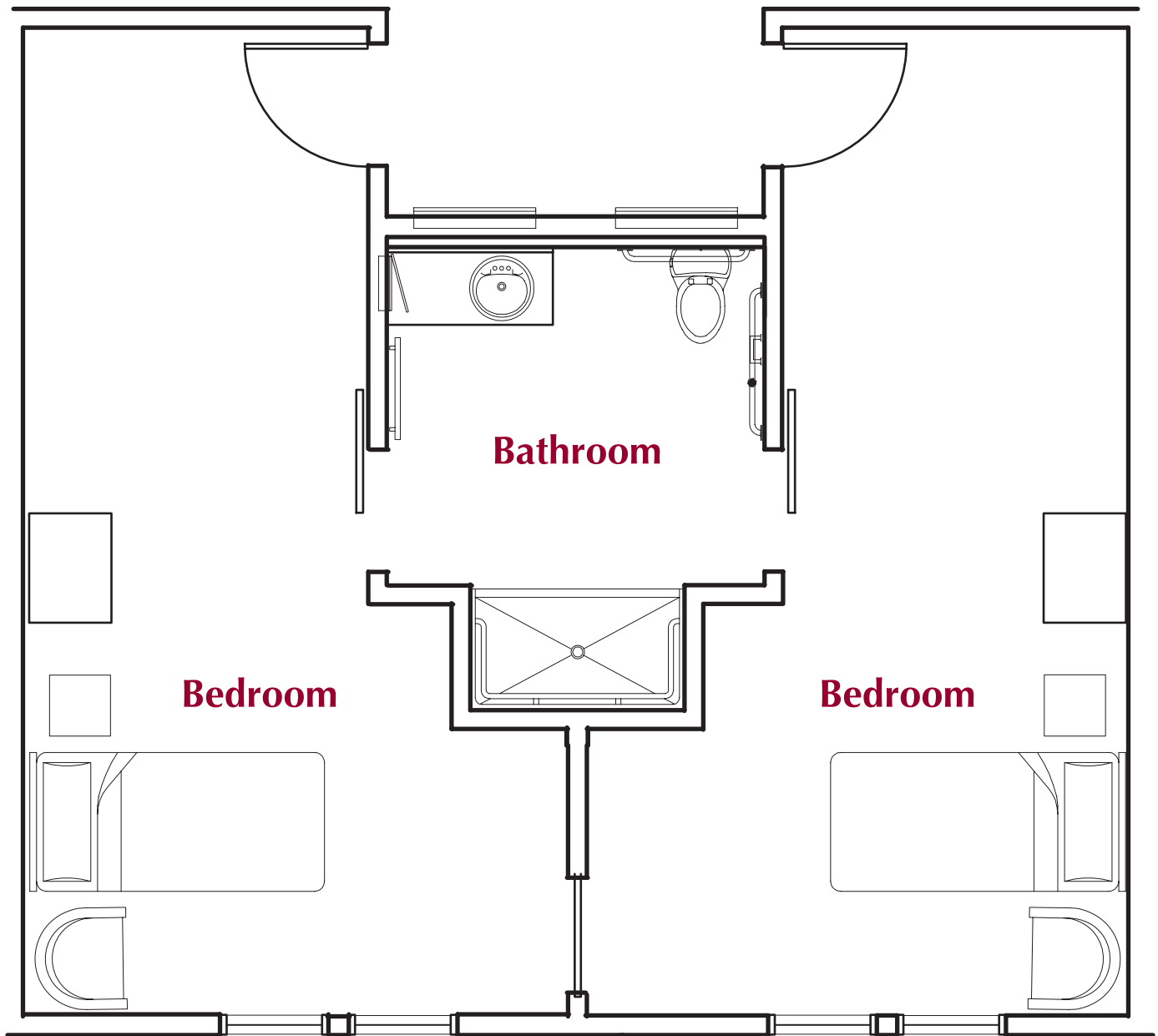

Waterford Grand

Assisted Living and Memory Care

The Difference Between Living and Living Well

600 Waterford Way | Eugene, OR 97401
541-636-3329 | www.WaterfordGrand.com

*Square footage estimates based on architectural drawings

The Difference Between Living and Living Well



Memory Care

Memory Care at Waterford Grand is designed around our belief that in the right setting, individuals experiencing memory loss or dementia can continue to enjoy a meaningful, purpose-filled life.

In this comfortable, caring and respectful environment, your loved one can make real connections and enjoy activities that bring joy, purpose and passion to his or her life. Our specially trained memory care professionals will provide personalized care, support and encouragement to ensure your loved one is able to take full advantage of his or her strengths and capabilities.

In private suite or double suite units ranging from 305 to 657 square feet, our Memory Care offers comprehensive services for your loved one.

All of our Memory Care apartments come complete with the following included:

- Encouragement through cueing with activities of daily living
- Assistance with daily dressing (a.m./p.m., includes cognitive assistance, reminders and redirection)
- Assistance with grooming
- Bathroom assistance
- Bathing and showering assistance (twice weekly)
- Escorts to activities
- Personal laundry
- Transportation
- Daily housekeeping
- Individualized activity programming
- Emergency assistance / 24-hour staff
- Medication assistance (storing, administering, assisting and supervising of prescriptions and OTC medications)



Waterford Grand

Assisted Living and Memory Care

The Difference Between Living and Living Well

600 Waterford Way | Eugene, OR 97401
541-636-3329 | www.WaterfordGrand.com

*Square footage estimates based on architectural drawings

The Difference Between Living and Living Well

